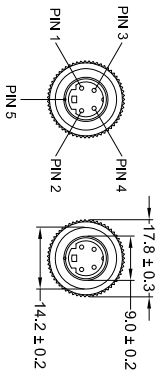

TABLE 1: BE-90XC CAMERA ONLY OPTIONS

PART NO.	MODEL NO.	DESCRIPTION
5281	BE-900C-C	CAMERA, ELITE, IMAGE CORRECTION, HEATED, ULTRA-LOW-LIGHT, PAL, CAMERA ONLY
5282	BE-901C-C	CAMERA, ELITE, IMAGE CORRECTION, HEATED, ULTRA-LOW-LIGHT, NTSC, CAMERA ONLY

Revision Notes			
R1 -	Drawn -	Checked -	Approved -
AP.A -			Date -

VIEW A



4 PIN MINI DIN MALE MATING FACE

PIN #	WIRE COLOUR	DESCRIPTION
1	YELLOW	VIDEO
2	RED	+12V
3	BLUE	N.C
4	WHITE	AUDIO
5	BLACK/SHIELD	GND

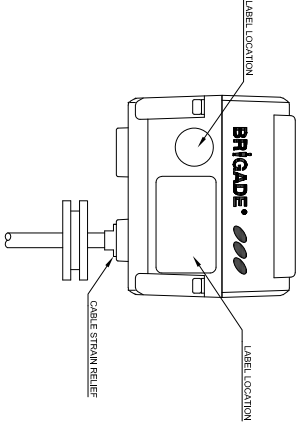
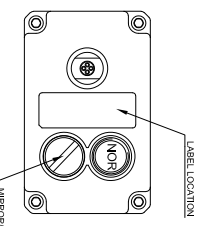
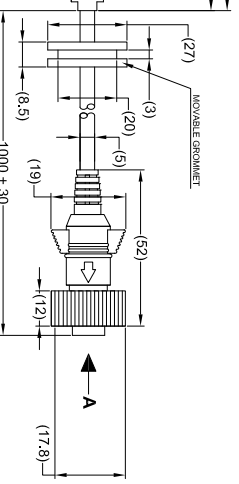
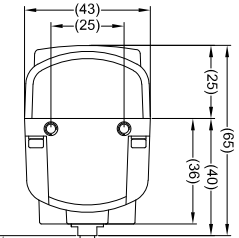
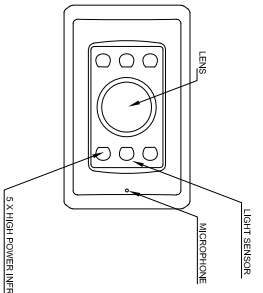
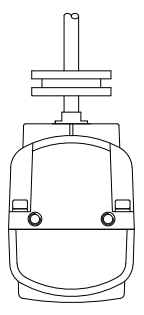
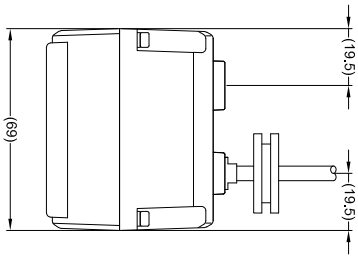

- NOTES:**
1. REFER TO PRODUCT SPECIFICATION FOR MORE DETAILS.
 2. FOR PRODUCT LABEL AND PACKAGING INFORMATION REFER TO MASTER BOM
 3. ANY CUSTOMER MODIFICATION OF THIS PRODUCT CAUSING SUBSEQUENT FAILURE IS NOT A LIABILITY OF BRIGADE ELECTRONICS PLC.

PROPRIETARY NOTICE
 THIS DESIGN AND TECHNICAL INFORMATION APPEARING ON THIS DRAWING IS THE PROPERTY OF BRIGADE ELECTRONICS, AND IS DISCLOSED IN CONFIDENCE. IT IS NOT TO BE COPIED, REPRODUCED, REVEALED TO OR EXPLOITED BY OTHERS, EITHER IN WHOLE OR IN PART WITHOUT THE EXPRESS WRITTEN CONSENT OF BRIGADE ELECTRONICS.

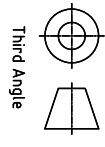

Assembly PI Approval T.LIM (18/05/18)		Approved by B.JOHN		Checked by W.BEAZLEY		Drawn by M.BUTLER	
Angle of Projection		Units mm	Scale N/A	Released 24/05/18		Assembly Ref -	
Third Angle		Status RELEASED		Part No BE-90XC-C			
		SEE TABLE 1		BE-003595-00-17			